



What's on the ballot?

BOND REFERENDUM
Question #1 - \$155,000,000



\$0.00 PER MONTH
BOND IS FOR BUILDING

If approved, keeps tax rate the same (due to old debt being replaced with new) while funding necessary building improvements and maintenance. These dollars would be used for a new elementary school to serve Grant and Lincoln students, district-wide safety and security updates, elementary and middle school remodels and additions, modernization, infrastructure and technology improvements.

OPERATIONAL REFERENDUM
Question #2 - \$3,000,000



\$0.00 PER MONTH
LEVY IS FOR LEARNING

If approved, keeps tax rate the same (due to old debt being replaced with new) while funding the additional staffing needed to provide full pupil service teams at each elementary school. These dollars would also be used for operational expenses.

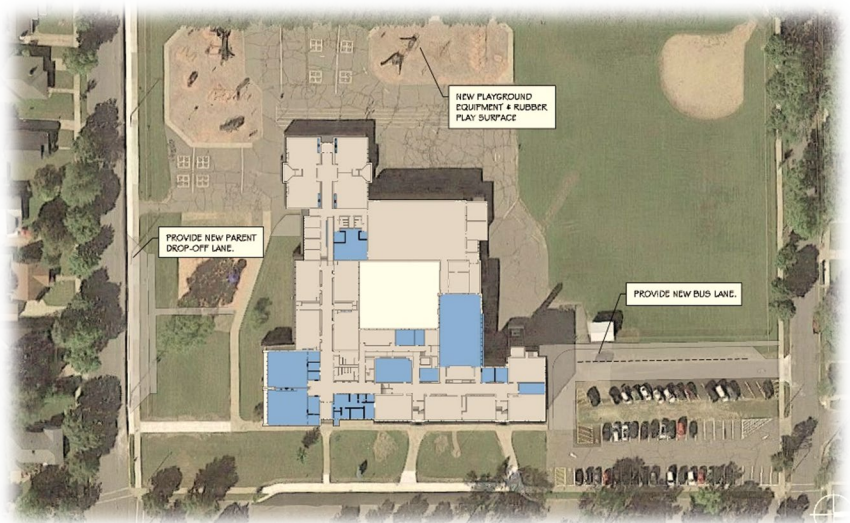

John Marshall Elementary

If passed, the November 3rd referendum would include the funding needed to make the following improvements at John Marshall:

Safety & Security Enhancements

- Remodel main office area to enhance secure entry
- Reconfigure parent/bus traffic lanes for safer drop-off and pick-up
- Upgrade fire alarm, clock and PA systems, emergency generator

Learning Space Modernization

- Renovate existing office area to provide staff and student support spaces
- Relocate Kindergarten entry and classrooms and remodel existing rooms into maker spaces for project-based learning, as well Art, Science and student support spaces
- Create community room for co-curricular and community events
- Toilet room renovations and ADA upgrades
- Update technology (equipment, spaces, access)

Building Repairs

- Upgrade HVAC systems for improved air quality and temperature, add air conditioning
- Address required maintenance (windows, doors, floors, ceilings, LED lighting, casework, corridors)
- Update playground surfaces and equipment

Student Support Space Expansions

- Reconfigure existing Special Education spaces and add a Sensory room
- Add staff to provide full pupil services teams (Question #2)

SEE PROPOSED PLAN ON BACK

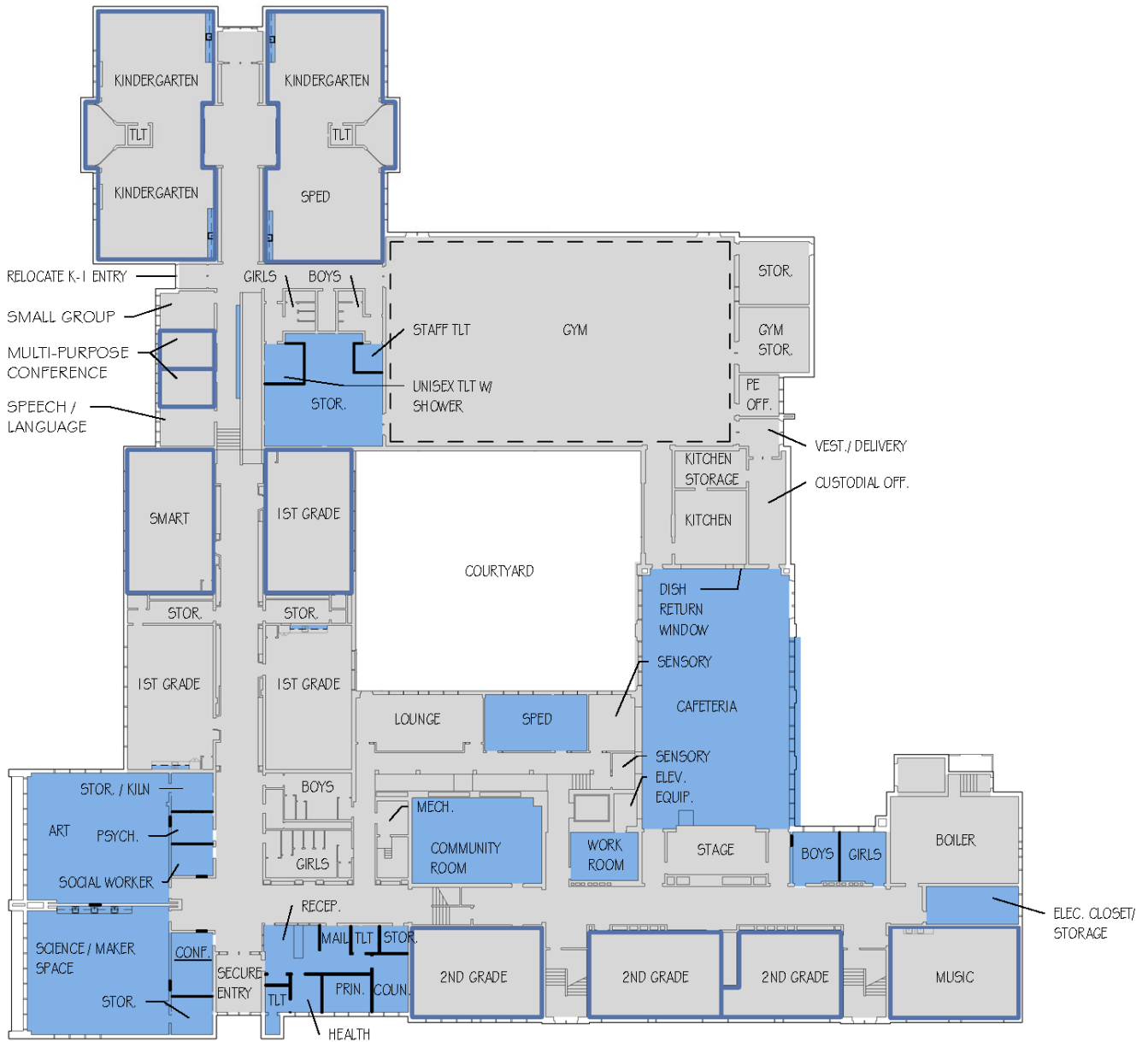

FIRST FLOOR PLAN

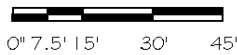

■	REMODELING
■	NEW ADDITION
■	REPURPOSING
■	DEFERRED MAINTENANCE